

Northland Village improvements - some ideas for council to improve our suburban centre

Northland Village Context:

Creswick Village, Northland, is a ridgeline connection between the central city, Kelburn, Wilton and Karori. The village is a small suburban centre on the 22 bus route and within a series of parks (Otari - Wilton's Bush, Town Belt, Ian Galloway Park, Zealandia, and Wellington Botanic Garden).

The shops are marked by a number of takeaway outlets, as a consequence the area has a rapid turnover of traffic. Coexistent with this traffic, are a number of community facilities, such as St. Anne's Church and Hall, the Northland Memorial Community Centre on Woburn Road, Northland School and Northland Park.

Northland Village Issues:

1. shops are generally fast food creating traffic congestion in evenings
2. demand for short term parking at peak times
3. poor connections between village and community memorial hall
4. village has no public flat area
5. local water supply is at risk following an earthquake
6. bus stop in shops confuses traffic and potentially unsafe
7. Garden Rd left turn is tight and potential traffic hazard
8. rubbish from fast food doesn't fit in bins
9. village feels tired and neglected

Northland Village Improvements:

1. create public space on pocket park integrated with new bus shelter
2. rainwater tank - local resilience provision
3. improve path to community hall - lighting and planting
4. increase parking generally - provide car parking on shady side of street
5. area for outdoor seating on sunny side of street (outside tables for future cafe / parking)
6. pave Northland Road - traffic calming shared space
7. move bus stop ? and pedestrian crossing / add pedestrian crossing
8. ease left turn into Garden Rd
9. provide bins that suit fast food (pizza boxes)
10. new village gateway - signage
11. community notice board - new location?
12. Northland Community Centre – enclose entry forming an outdoor verandah, constructed of lightweight danpalon polycarbonate, to produce a transparent entrance space and shelter in front of the community centre. The aim is to increase the flat space outside the centre to allow for community gatherings - potential to extend paving across street as potential temporary street market etc.

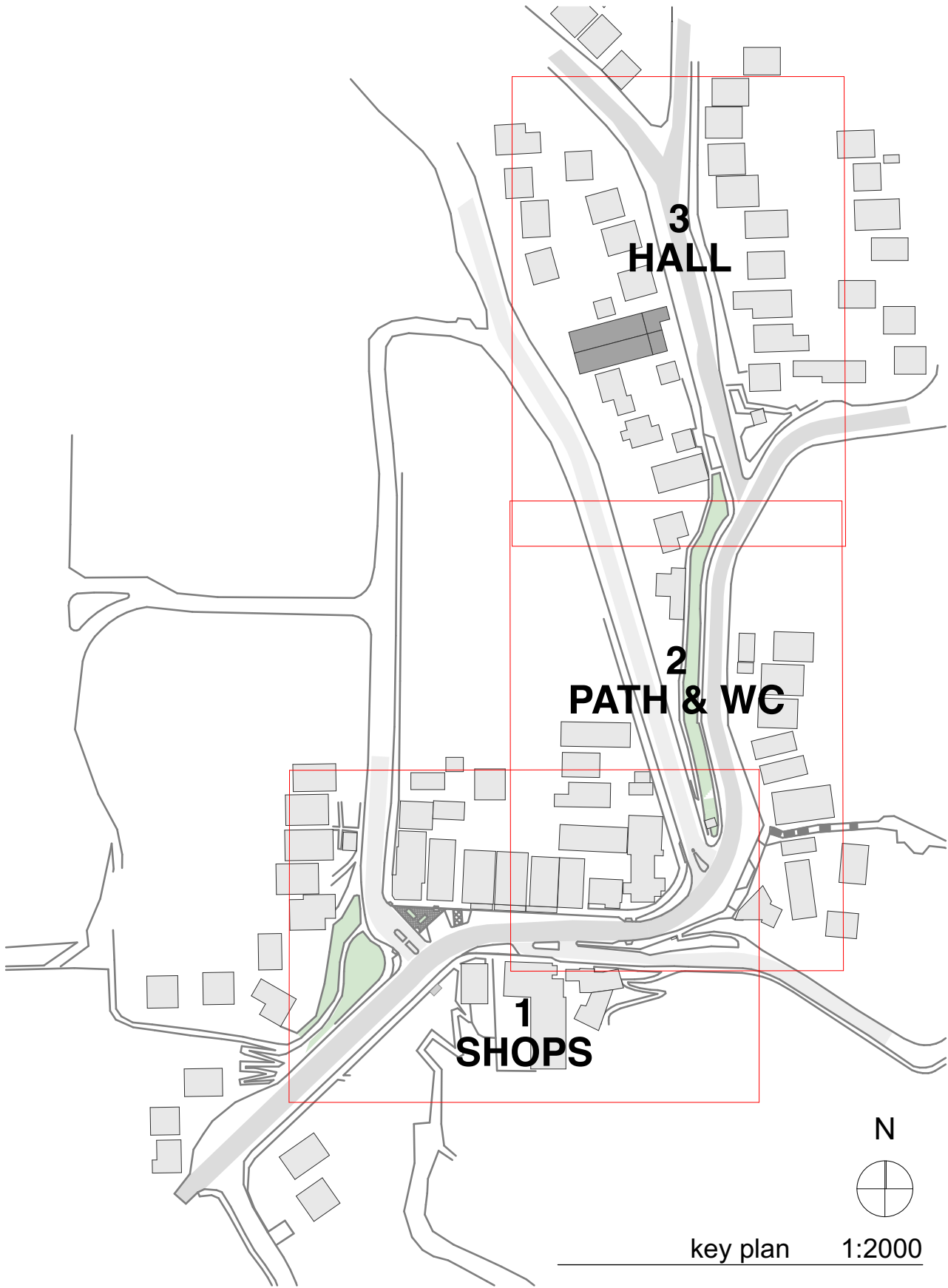

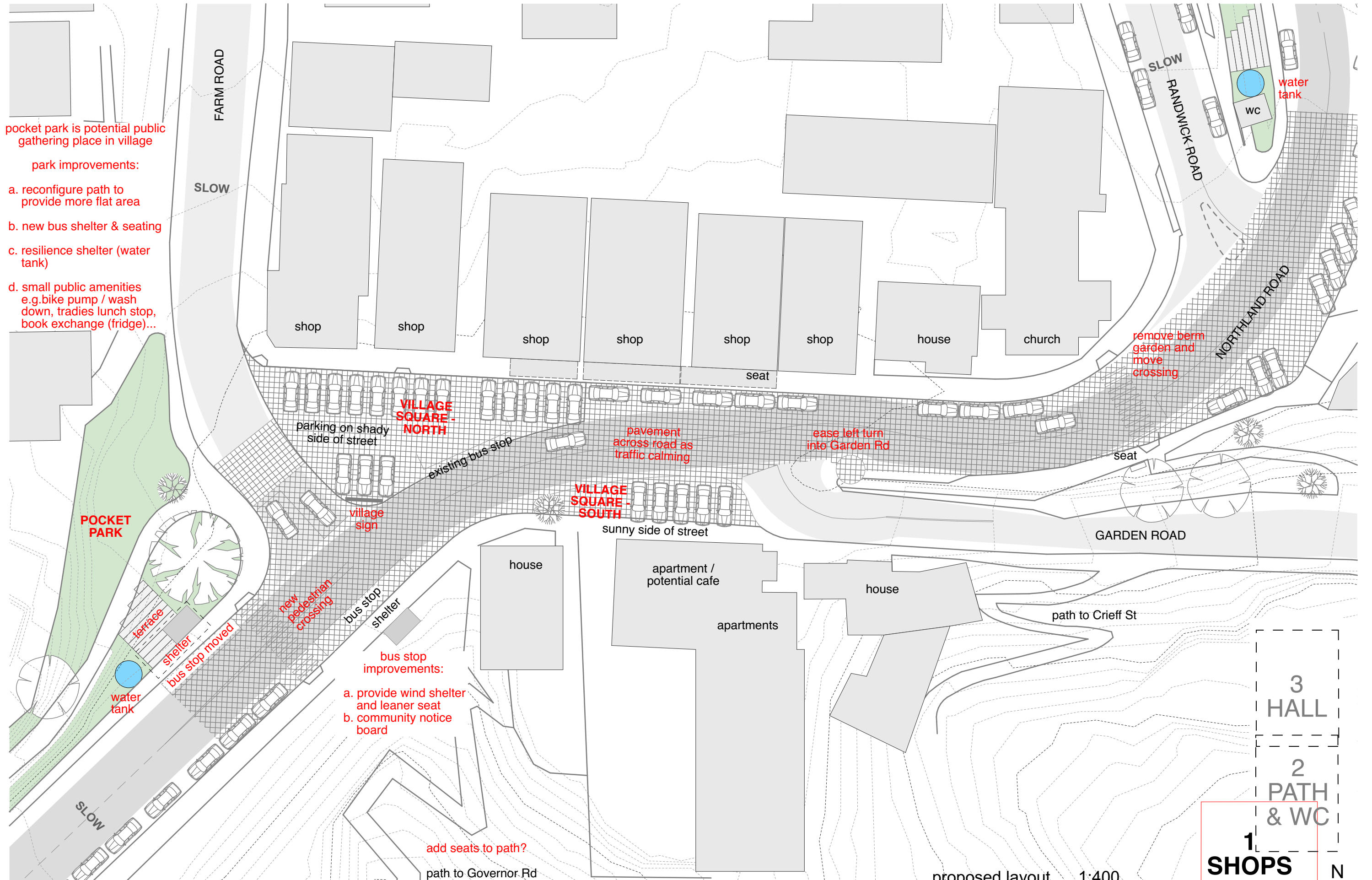

pocket park is potential public gathering place in village

park improvements:

- a. reconfigure path to provide more flat area
- b. new bus shelter & seating
- c. resilience shelter (water tank)
- d. small public amenities e.g.bike pump / wash down, tradies lunch stop, book exchange (fridge)...

- bus stop improvements:
- a. provide wind shelter and leaner seat
 - b. community notice board

Northland Village Improvements

project reference:

shops - proposed

drawing name:

proposed layout
prop1 revB

drawing ref: drawing revision:

1:400

1/03/18

date issued:

A3
original
drawing

0 1 2 3 4 5 6 7 8 9 10
A3 original drawing



Toilets are very popular with tradesmen, taxi drivers, gardeners, walkers and cyclists who would enjoy lunch area in pocket park at west end of village.

- lighting
- new planting

- new planting
- fruit trees
- native

terrace /
garden

water tank
collection
for
resilience

- steps work out
- altitude marker
- steps count
- add lighting

3 HALL

2 PATH & WC

SHOPS

proposed plan 1:400

prop2 revB

1/03/18 A3
date issued: original
drawing

Northland Village Improvements
project reference:

toilet and path - proposed

drawing name:

drawing ref: drawing revision:

Northland Community Centre –
enclose entry forming an outdoor
verandah, constructed of lightweight
danpalon polycarbonate, to produce
a transparent entrance space and
shelter in front of the community
centre. The aim is to increase the flat
space outside the centre to allow for
community gatherings

Extend paving across street as traffic
calming and as temporary activities
place - street market, community
dinner etc.

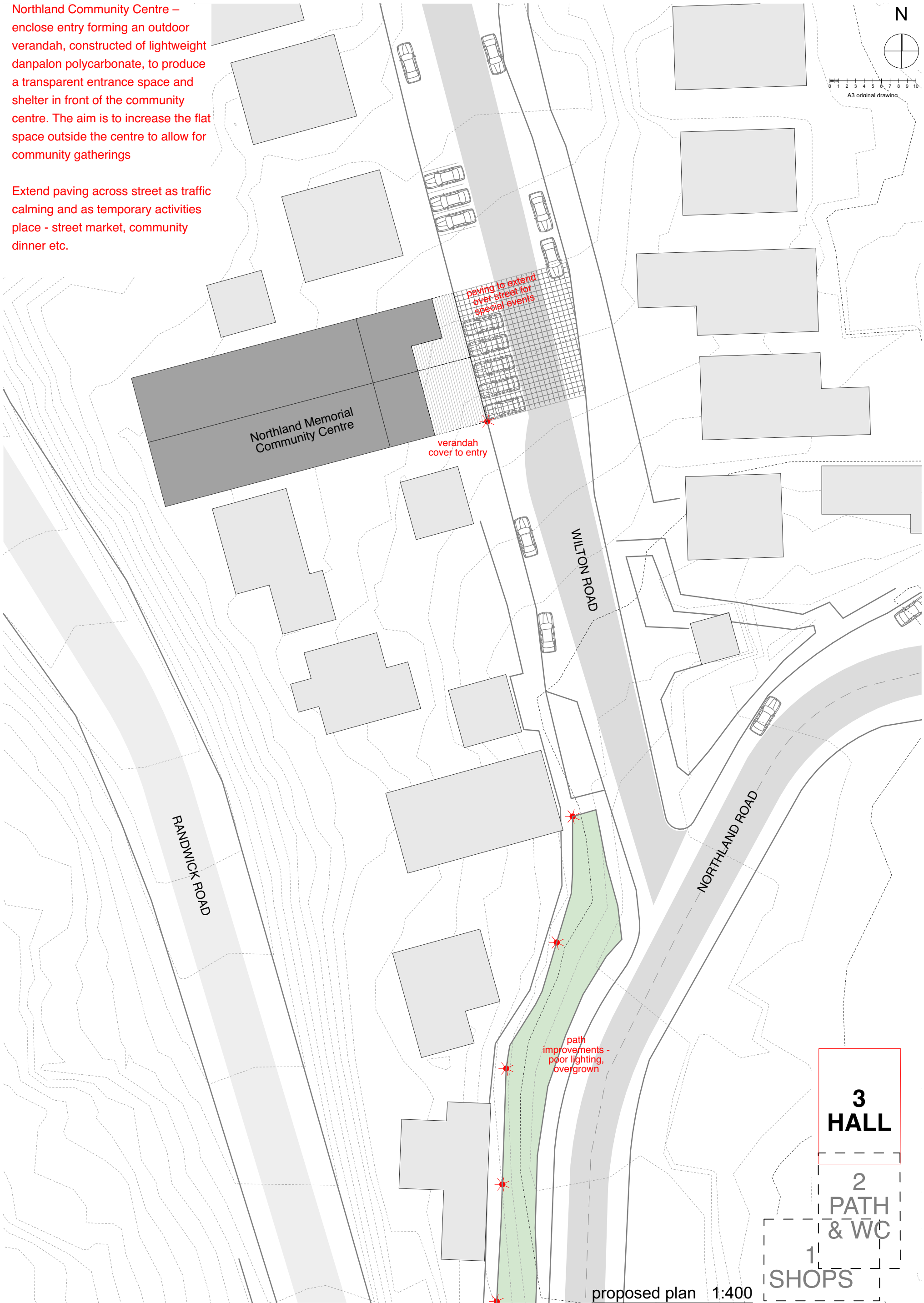



Northland Village Improvements
project reference:

shops - existing
drawing name:

existing plan 1:400
extg1 revB
drawing ref: drawing revision:

1/03/18
date issued: A3 original drawing

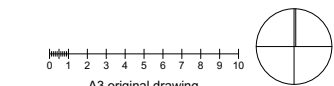

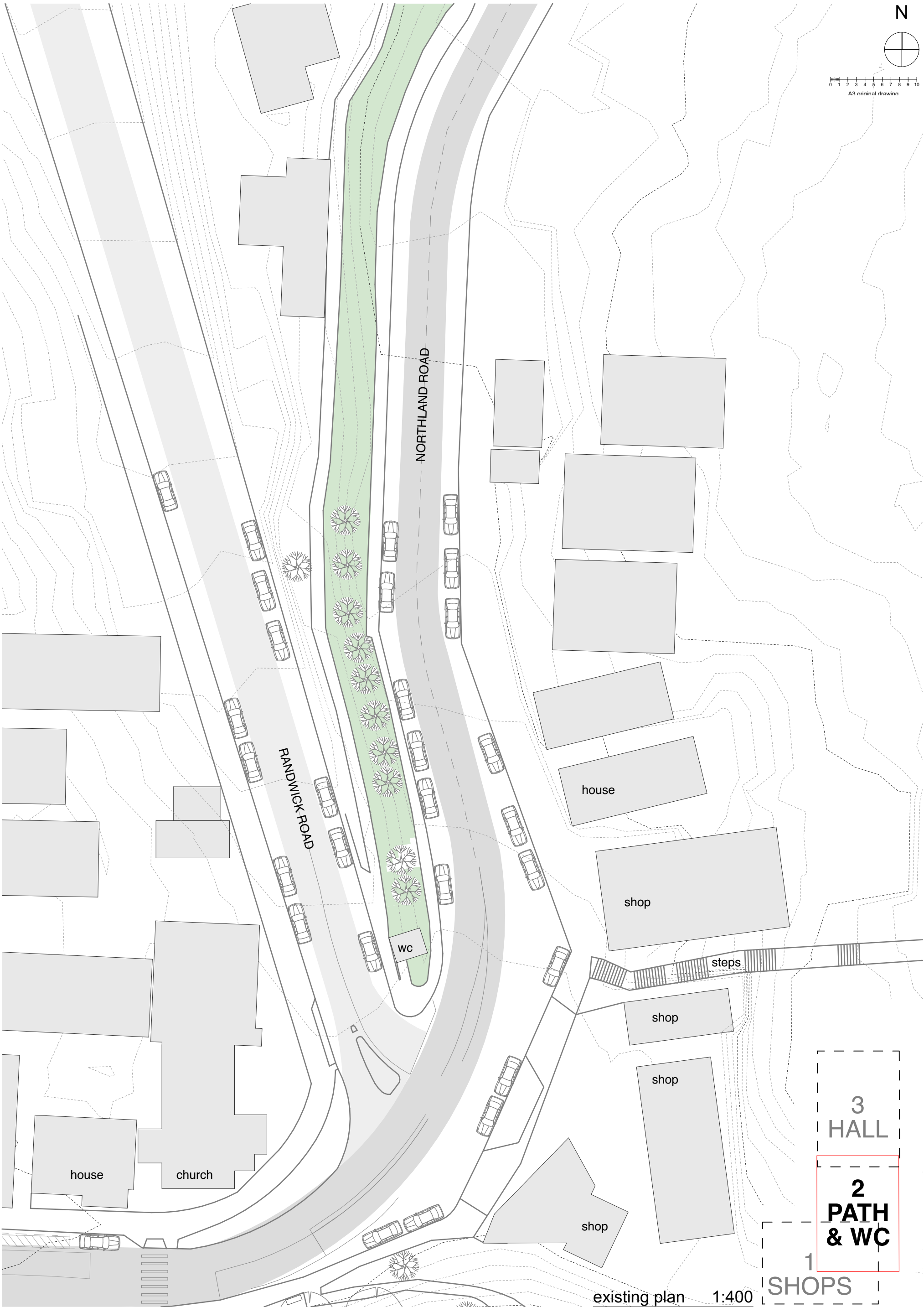

Northland Village Improvements
project reference:

toilet and path - existing
drawing name:

existing plan 1:400
extg2 revB
drawing ref: drawing revision:

1/03/18
date issued: A3 original drawing

